



Farmers Electric Cooperative

A Touchstone Energy[®] Cooperative 

301 N. Hillcrest
Sulphur Springs, TX 75482

2000 I-30 E
Greenville, TX 75402

108 W. Marble
Wylie, TX 75098



Thursday, April 12, 2018

Office of Hopkins County Judge
Robert Newsom
PO Box 288
Sulphur Springs TX 75483

Farmers Electric Cooperative Member: David C Barington
Service Order Number: 1803004186

Greetings:

Farmers Electric Cooperative, Inc. is requesting permission to construct electrical power distribution facilities across CR 4767 which is located, approximately 3740 feet S of FM 71 in Hopkins County, Texas.

Site location map and construction sketches are enclosed. The construction sketch details the proposed work. All road crossing will have a minimum vertical clearance of 22 feet.

If you have any questions, please contact me at any time.

Sincerely,

Matthew Walker
Project Coordinator

mwalker@farmerselectric.coop
Phone 903-441-1368

Submitted by Damaris Rivera
Field Engineering Coordinator

Enclosures

OK.
Danny Evans
Commissioner Act. 4



Sunrise

71

71

71

71

71

71

71

71

71

71

71

71

71

71

71

71

71

71

71

71

Farm Road 71 W

County Road 4768

County Road 4769

County Road 4770

County Road 4771

County Road 4772

County Road 4773

County Road 4774

County Road 4775

County Road 4776

County Road 4777

County Road 4778

County Road 4779

County Road 4780

County Road 4781

County Road 4782

County Road 4783

County Road 4784

County Road 4785

County Road 4786

County Road 4787

HOPKINS

Farmers Electric Coop
SO#1803004 186
David C Barinaton

0.5 mi

Latitude: 33.269251 Longitude: -95.631486

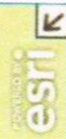

Esri, HERE, Garmin, INCREMENT P, NGA, USGS



P2.20' TO CR 4767
& 3740' TO FM 71

EASEMENT HORN

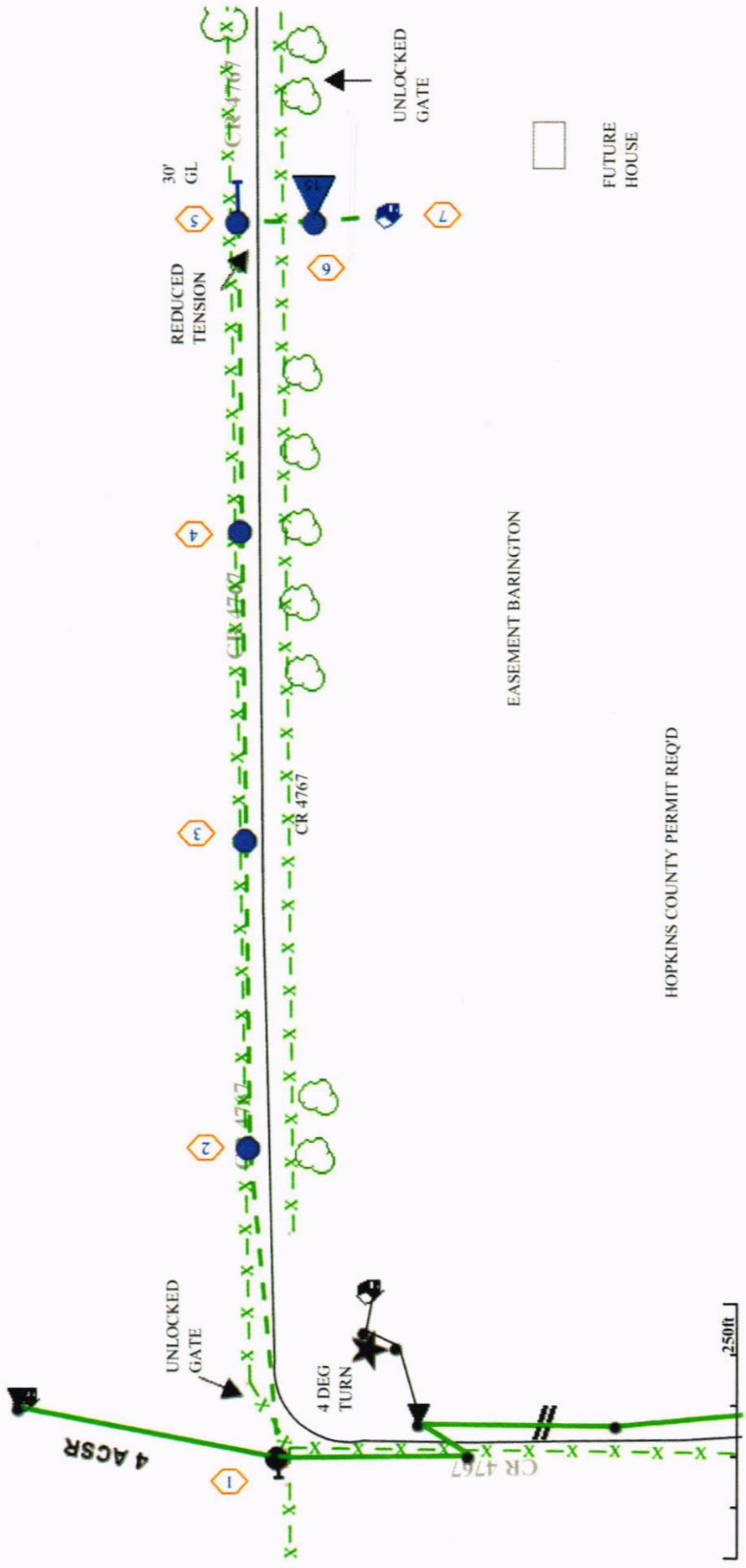

HOPKINS COUNTY PERMIT REQ'D